

# soluCLEAN

## Auto Dishwash



### Dilution ratio

1 sachet per wash cycle

Suitable for use in all auto dishwashers. Excellent machine cleaning with built in rinse aid.



## Instructions



1. Loaded dishwasher.

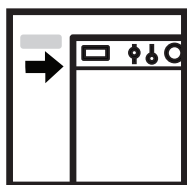

2. Add sachet.

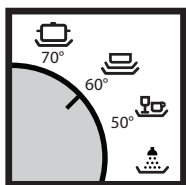

3. Select cycle.



4. Ready to use.

## Where to use



Dishwasher

Solupak  
Product  
Code:

| SCSP50DWP

## Classification

POWDER ONLY

ONCE DILUTED



NOT CLASSIFIED  
UNDER CLP

But the sachets outer film keeps you safe

## Best practice

We don't like harming people or the environment so our products are not hazardous when they are diluted. The powder in the sachet is hazardous however we have wrapped it up safely in water soluble film so you don't come into contact with it.

### Please make sure you:

Store the sachets in a dry area and keep them inside the packet until you need them.

Only handle the sachets with dry hands. If any sachets are damaged please do not handle them without wearing PPE and always avoid the powder making contact with your eyes or skin.

Read and follow the safety data sheet provided.

Always follow the colour coding.

Once diluted the solution is not classified with any hazard.

Type:

| Sachet

pH in use:

| 10-11

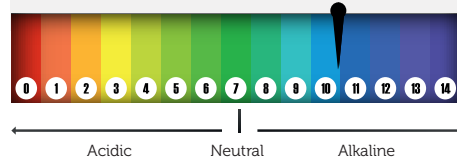

Colour:

| White